

DESIGN STUDIO 3 - EXHIBITION



LOU-MING MAXIME JEAN DASTOT
MANKUMARE ASHIKA BAPUSAHEB
MANGERI GIREESH
PHAM DUC DUONG



C O S C A S

O F E O N D E
U N T V N
N C H e
I
L

o n t i n e n t s

e a s



COSCAS is the almighty entity that has hand chosen Guardians as their representatives.

With the Guardians' help, Ranger Buddies are able to complete their missions and develop their C.O.U.R.A.G.E strengths, learning more about the natural world and how to better protect the Earth and its inhabitants

**Get ready Ranger Buddies
you are here to
protect the earth**



A person wearing a red backpack is walking across a narrow wooden bridge in a dense, lush jungle. Sunlight filters through the trees, creating a warm, golden glow. The background is filled with various tropical plants and trees.

CONCEPT HIKE

THE ADVENTURE TOUR

FUN
EXPLORE
INTERACT

CONCEPT

HIKE

- Encourages the children to test their limits.
- To cognitive abilities.
- To create opportunities for sensory learnings.
- Enthusiasm for physical activities.



A close-up photograph of a lizard, possibly a spiny-tailed lizard, resting on a light-colored, textured rock. The lizard has a mottled pattern of brown and tan spots and stripes on its body. Its head is turned slightly to the left, and its eyes are visible. The background is a soft, out-of-focus brown.

OUTPOST

TOPIC: REPTOPIA

DIVERSITY OF REPTILIAN ADAPTATIONS



OUTPOST

- Pitstop for ranger buddies.
- The previous Ranger Buddies have left notes to inspire the kids to embark on the Quest.

INSPIRATION

TRIBAL HUT - FOR STRUCTURAL DESIGN



STRUCTURE DESIGN PROCESS SKETCH



Cylindrical hut with conical roof

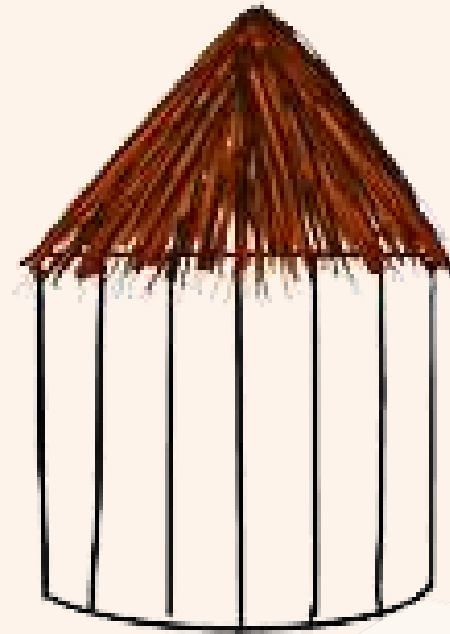

Cylindrical hut made with
bamboo
and conical roof

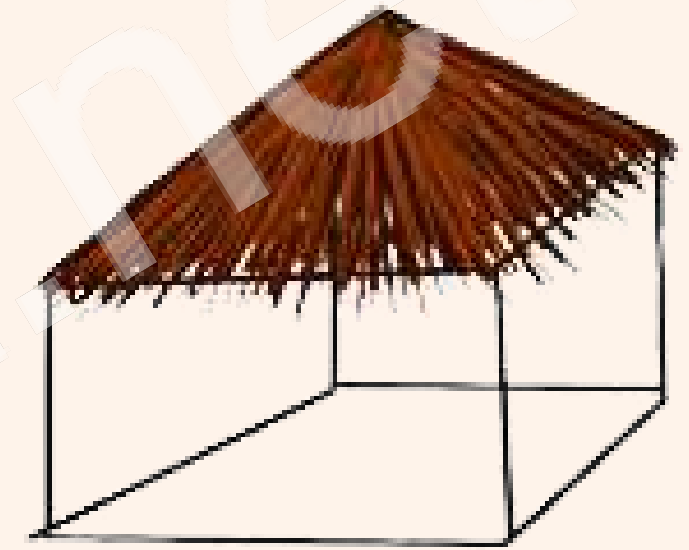

Square shaped hut

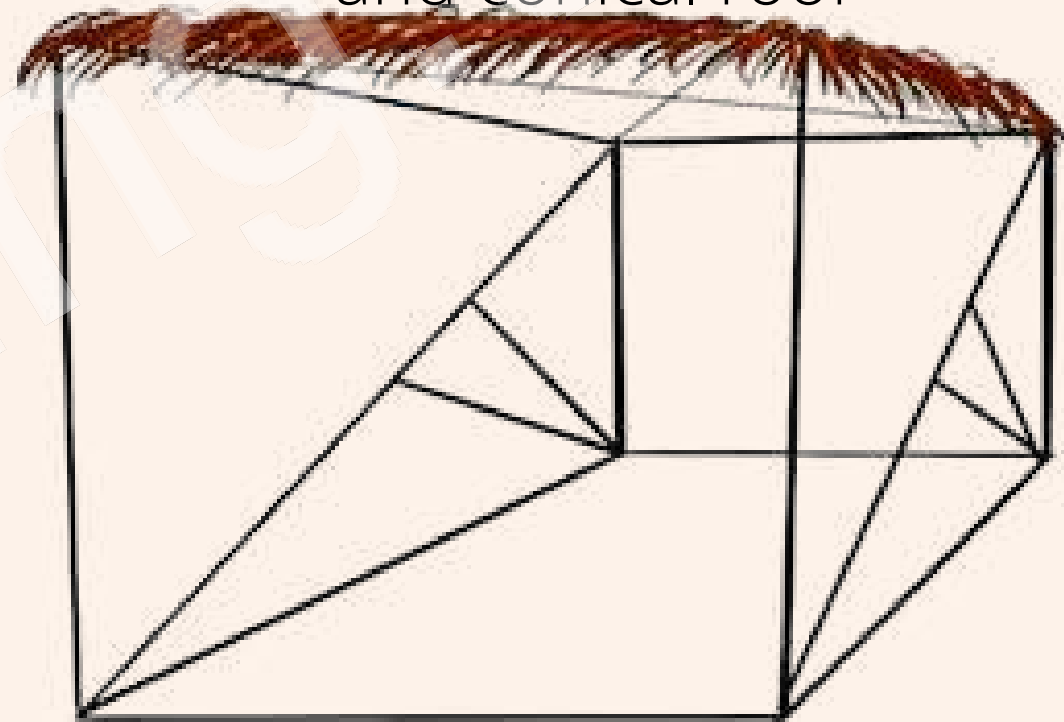

Final structure

Adaptation: Changing Colours



GREEN ANOLES

- A hormone secreted by the pituitary gland triggers the color change from green to brown.
- color changes in response to temperature fluctuation, their background, or their mood



CHAMELEON

- Chameleons change colors to attract mates, regulate body temperature, or tell intruders to stay away.
- The color of their skin helps them blend in with their habitats.

CHAMELEON

- BLOCKS INSPIRED BY A TIC TAC TOE GAME
- TO SHOW THE KIDS HOW CHAMELEONS CHANGE THEIR SKIN COLOUR TO HIDE AND PROTECT THEMSELVES



GREEN ANOLES

- THE SLIDING GAME IS INSPIRED FROM THE PLAYGROUND BOARD.
- KIDS HAS TO MOVE THE GREEN AND BROWN ANOLE FIGURES TO THE CORRECT TEMPERATURE.
- THE BROWN ANOLES HAS TO MOVE TO THE DARK TEMPERATURE
- THE GREEN ANOLES HAS TO MOVE TO THE DAY TEMPERTURE.







KIDZWORLD

INDOOR PLAY

KIDZWORLD INDOOR AREA

Content Focus : Tropical Rainforest

Entrance

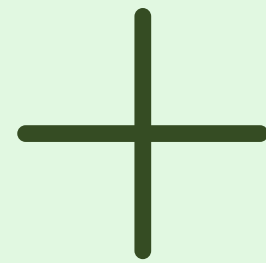

Briefing Area

- Introduction of Characters
- Mission Overview
- The Suiting Up Ritual
- The Ranger Buddies Cheer

Kai's Research
Lab

In field research: Forest animals discovery
[Learn & Connect]

- Locomotion
- Camouflage/ Mimicry
- Body Covering/ Parts

MOODBOARD



LAYOUT PLAN

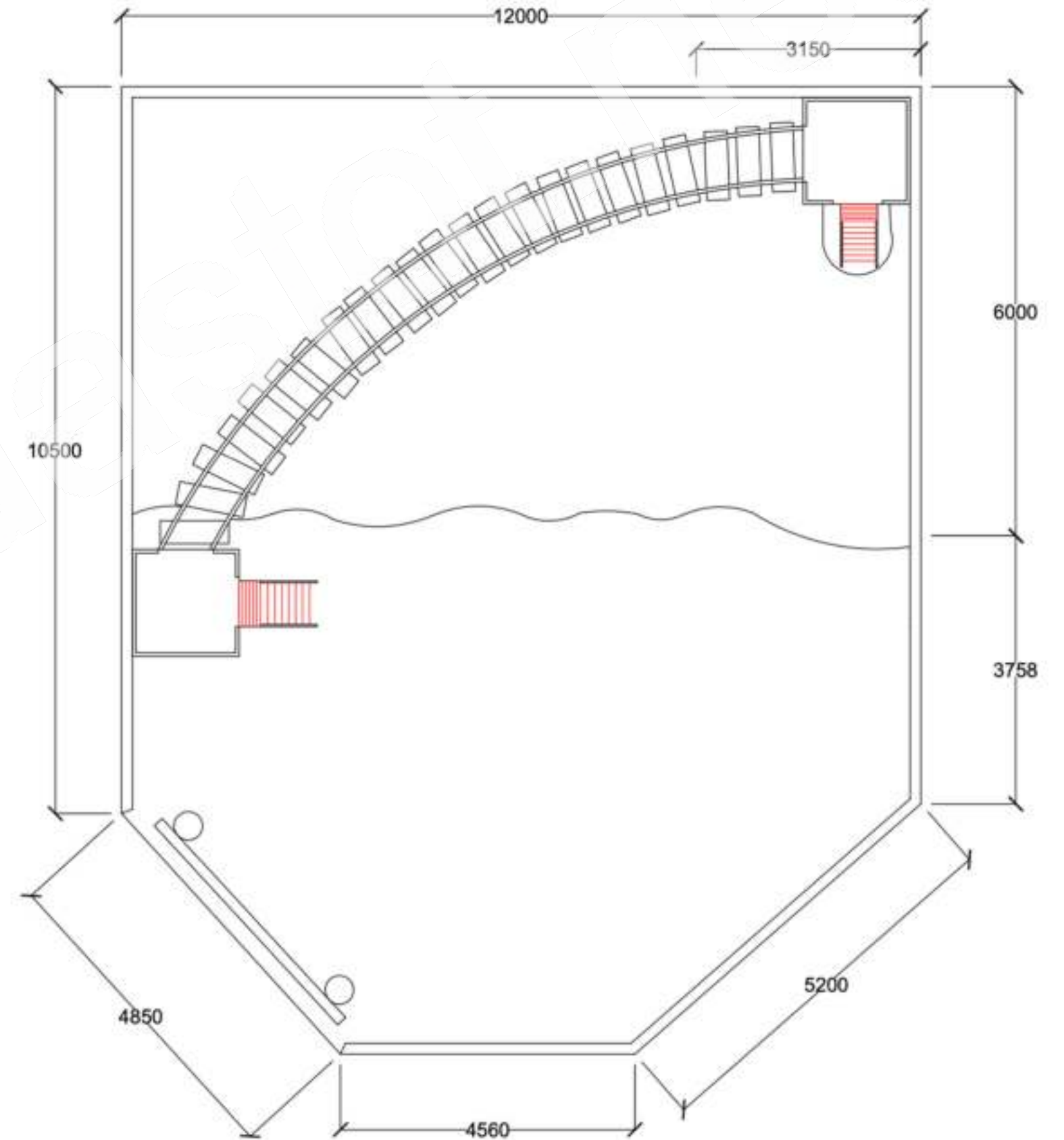
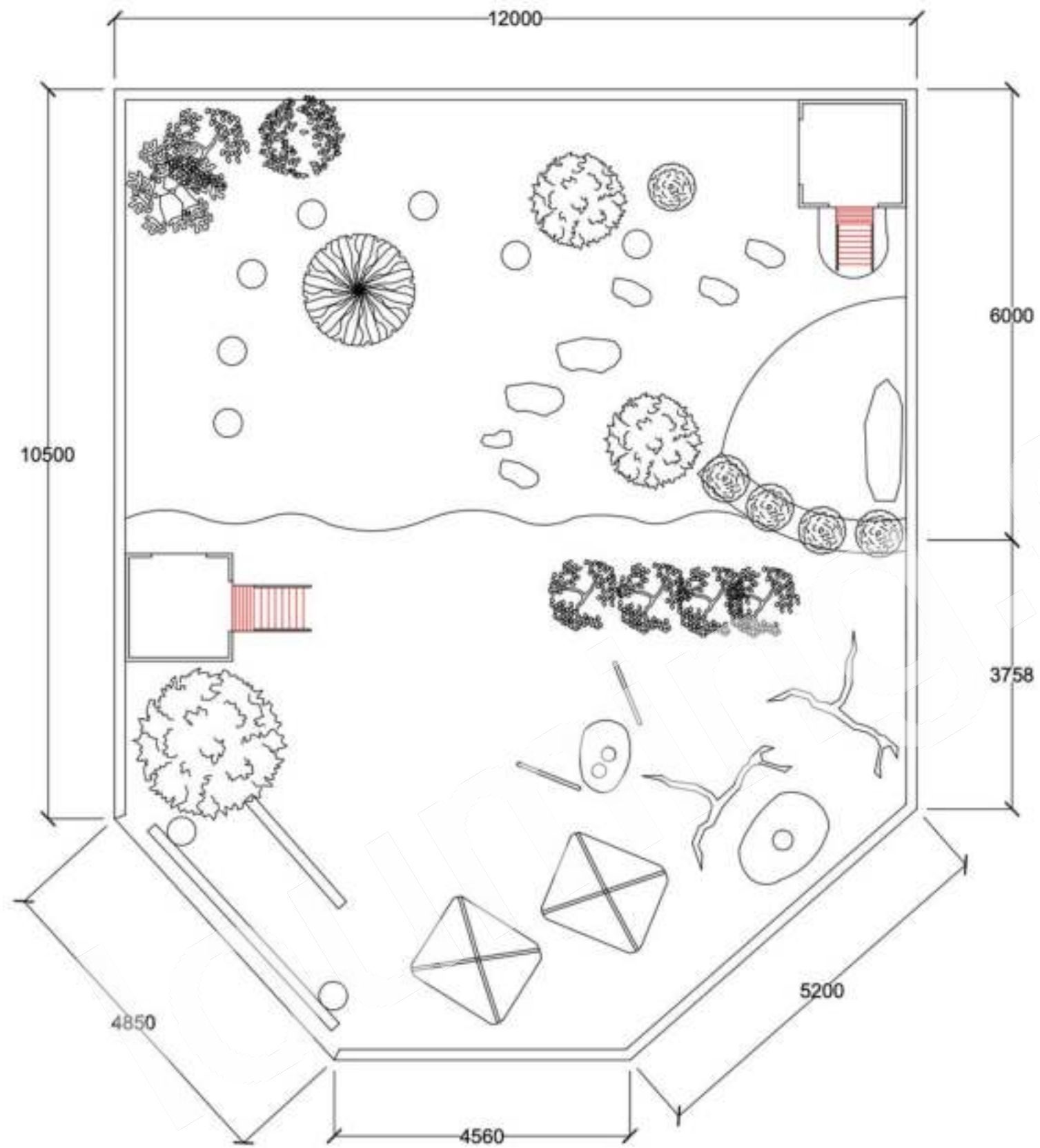

USER JOURNEY

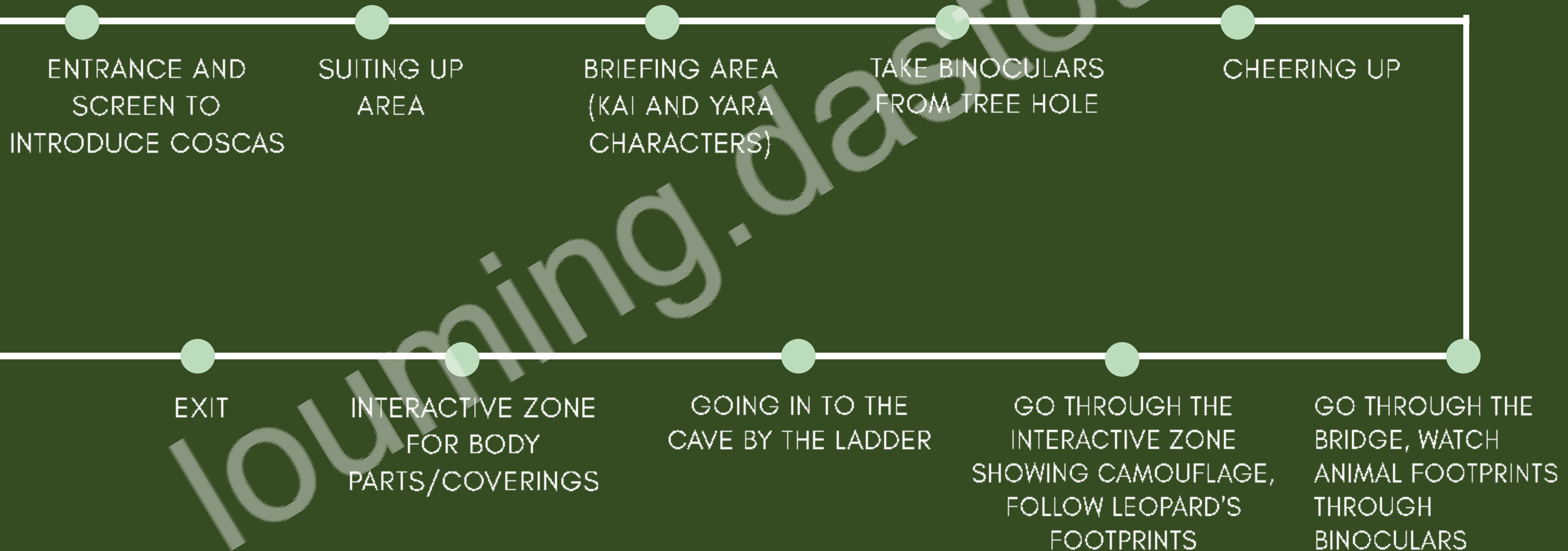

ENTRANCE + BRIEFING

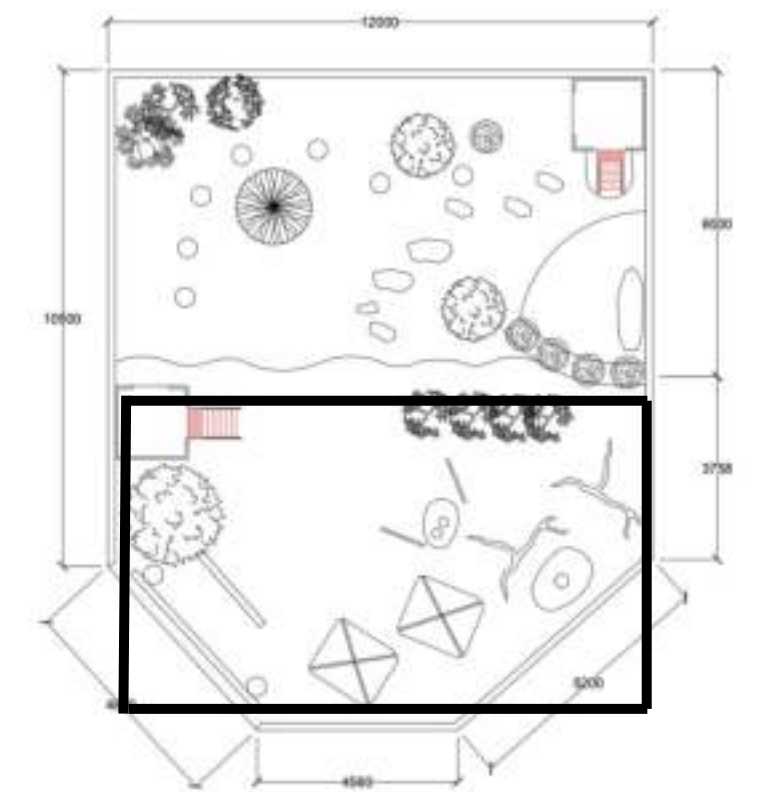

ENTRANCE + BRIEFING



KAI'S RESEARCH LAB

Research

LOCOMOTION

- THE ABILITY TO MOVE IS ESSENTIAL FOR SURVIVAL.
- MIGRATORY ANIMALS THAT TRAVEL VAST DISTANCES TYPICALLY HAVE A LOCOMOTION MECHANISM.

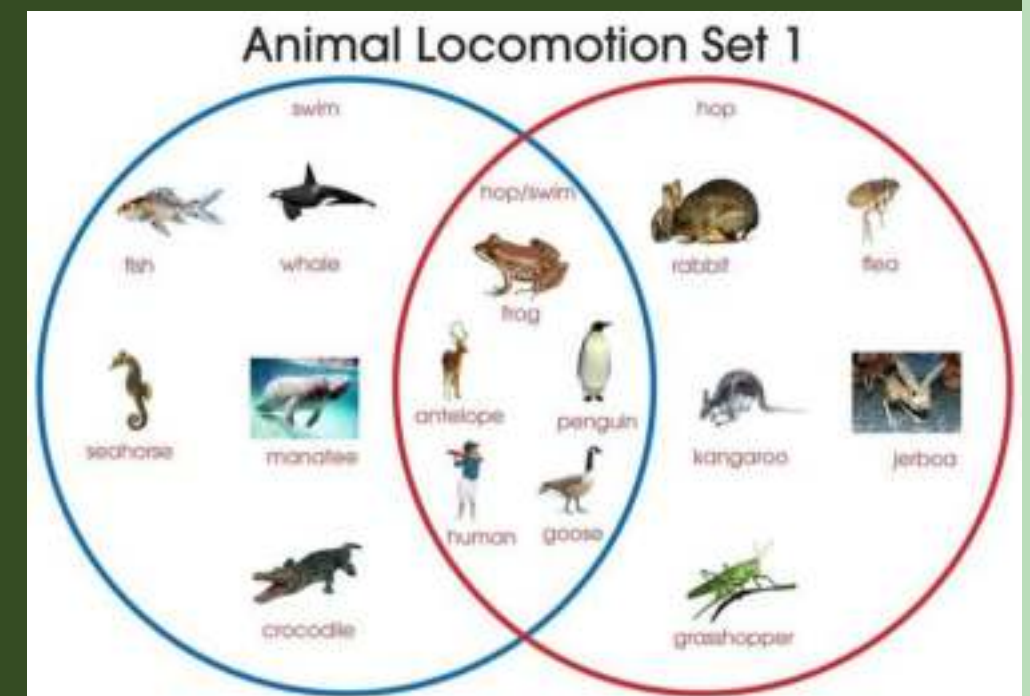
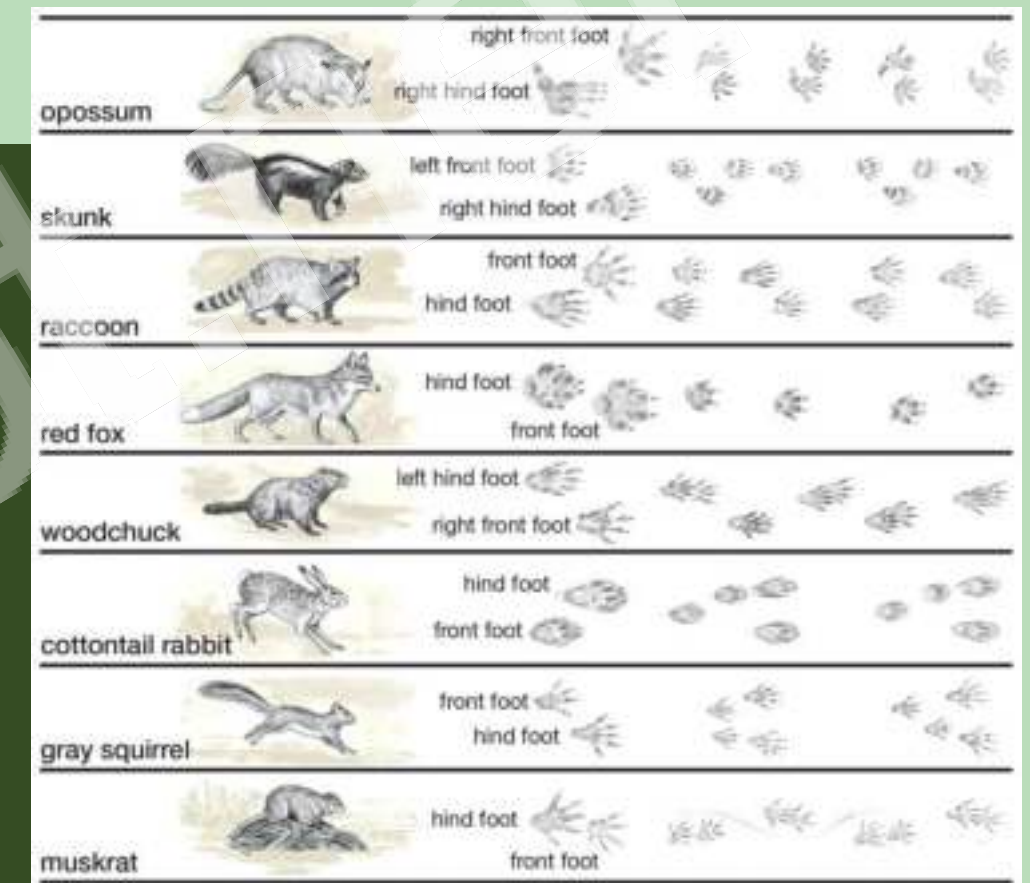

LOCOMOTION



- Circulation of space
- Showing food chain

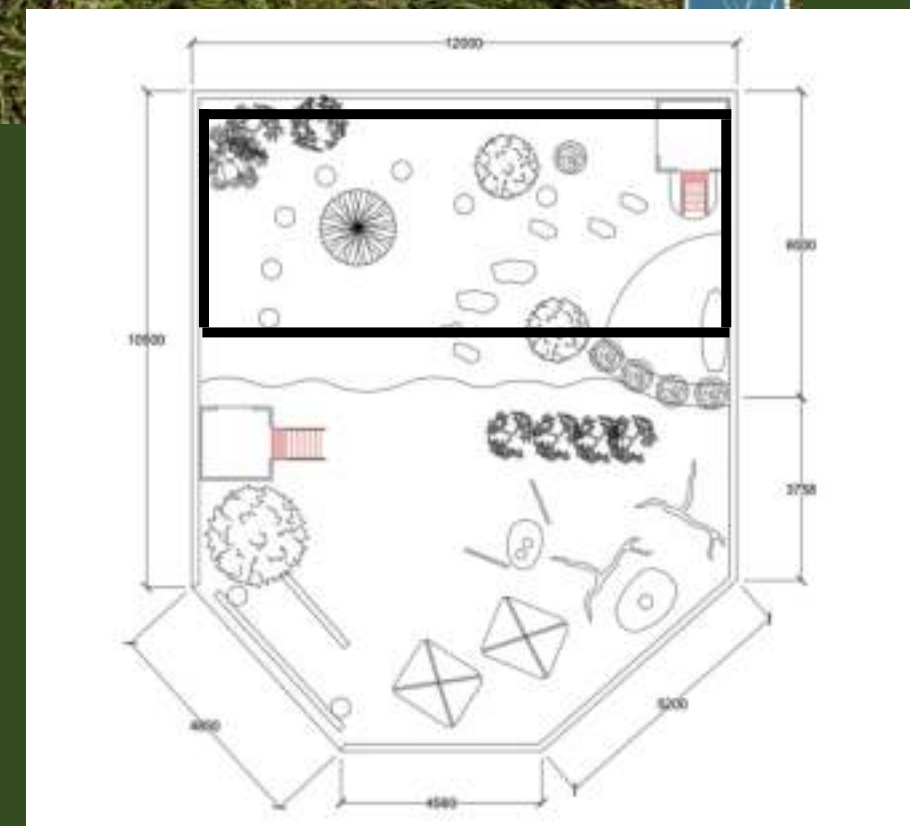

Research

CAMOUFLAGE/ MIMICRY

- Organisms use to disguise their appearance, usually to blend in with their surroundings.
- Organisms use camouflage to mask their location, identity, and movement



CAMOUFLAGE/MIMICRY



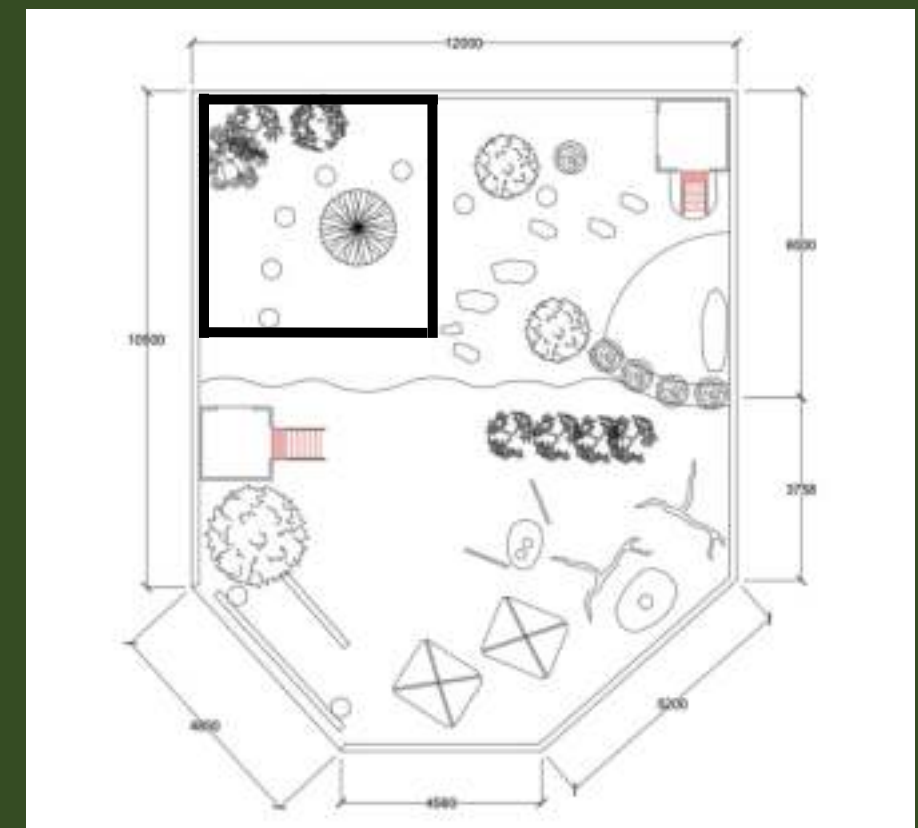

Research

BODY COVERING/ PARTS

- Animal body coverings are important as they keep the animal warm and dry, protect them from physical danger and help them hide from their enemies.



BODY PARTS/COVERINGS

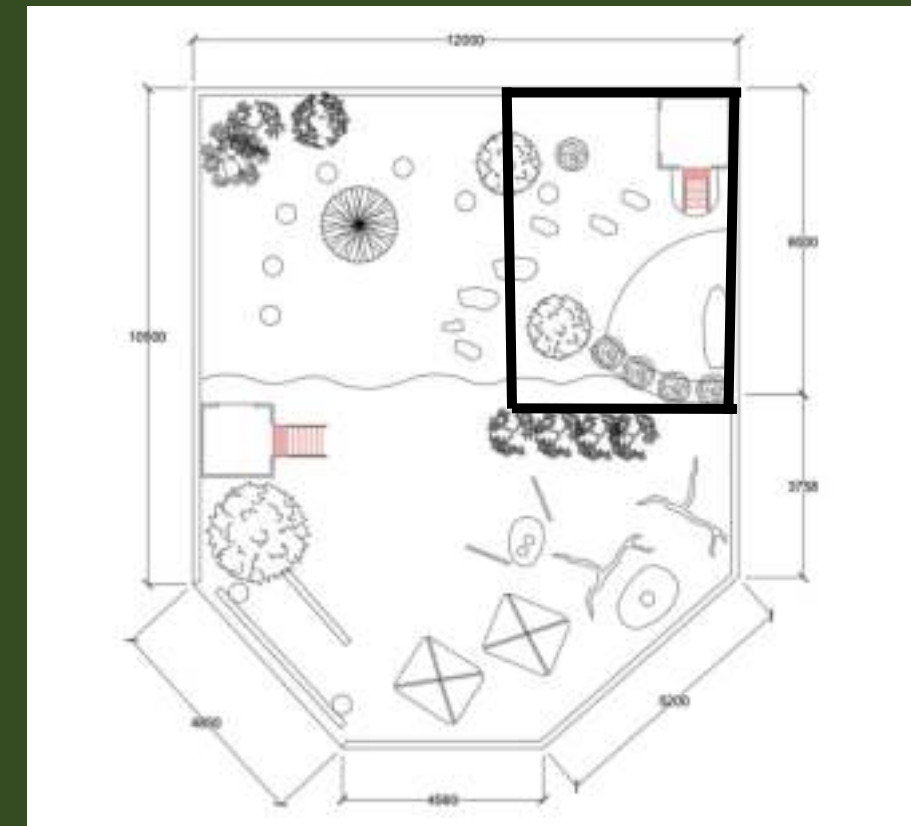

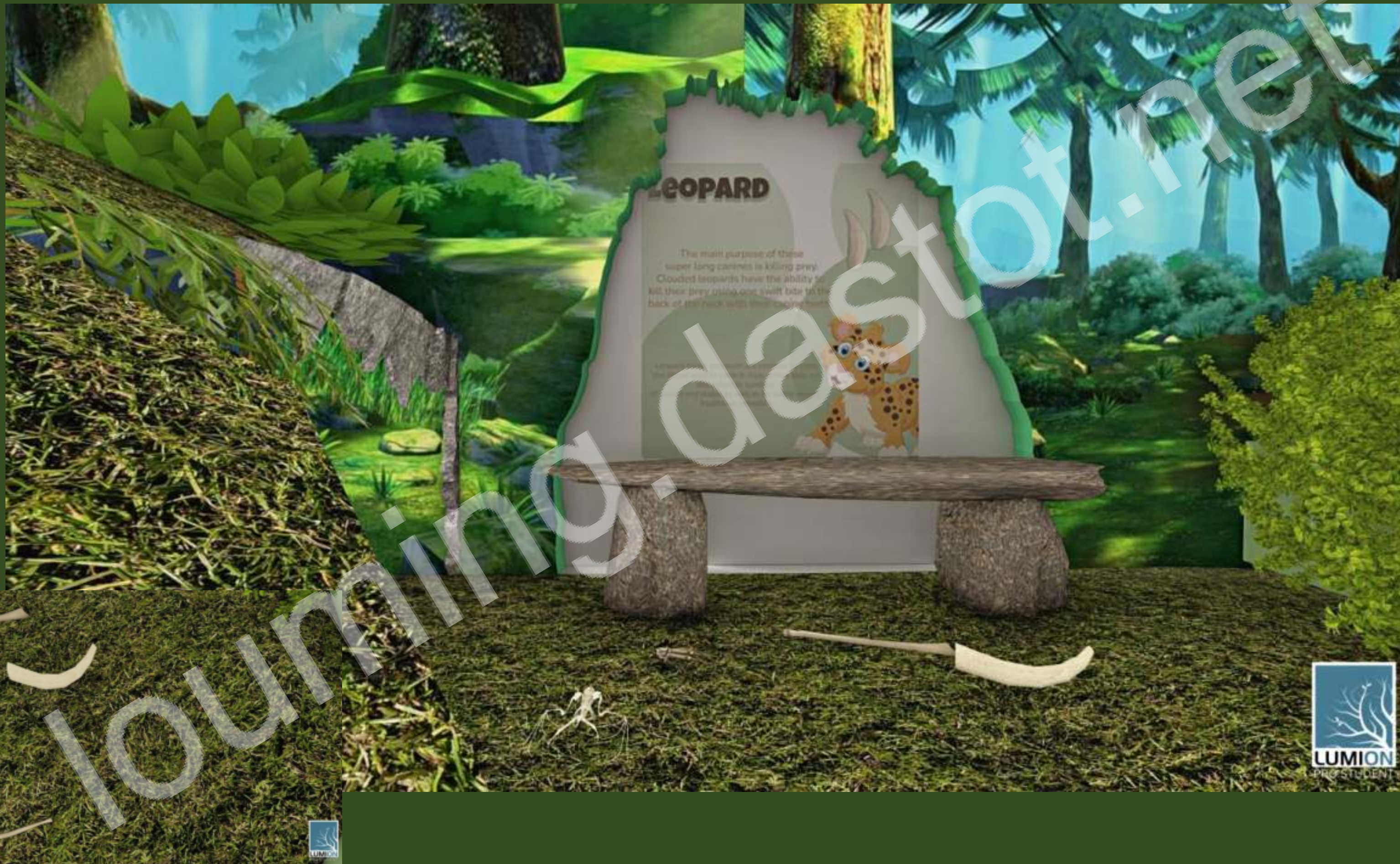

GRAPHICS FOR BODY PARTS AND COVERINGS

LEOPARD

The main purpose of these super long canines is killing prey. Clouded leopards have the ability to kill their prey using one swift bite to the back of the neck with their canine teeth.

Leopard bones and teeth are continue to enter the illegal wildlife trade in Asia, where they are still prized as symbols of wealth and status as well as for use in various traditional remedies.



DEER

The hooves are useful in running and climbing for deer. Deer bones are very important for them to protect themselves from the enemies.

Deer skin is poached which is used in many luxury products and to gain more money from that.



ELEPHANT

Elephants use their trunks and their tusks to protect themselves from predators.

Elephants are poached primarily for ivory.



EAGLE

An eagle will use its incredibly strong feet and sharp claws (talons) for defense.

An eagle can also inflict painful bites with its large, strong beak.



THANK YOU :)